



**NUMBER:** 17-001-15

**GROUP:** Rear Suspension

**DATE:** March 21, 2015

*This bulletin is supplied as technical information only and is not an authorization for repair. No part of this publication may be reproduced, stored in a retrieval system, or transmitted, in any form or by any means, electronic, mechanical, photocopying, or otherwise, without written permission of FCA US LLC.*

**THIS SERVICE BULLETIN IS ALSO BEING RELEASED AS RAPID RESPONSE TRANSMITTAL (RRT) 15-030. ALL APPLICABLE SOLD AND UN-SOLD RRT VIN'S HAVE BEEN LOADED. TO VERIFY THAT THIS RRT SERVICE ACTION IS APPLICABLE TO THE VEHICLE, USE VIP OR PERFORM A VIN SEARCH IN TECHCONNECT. ALL REPAIRS ARE REIMBURSABLE WITHIN THE PROVISIONS OF WARRANTY.**

***SUBJECT:***

Incorrect Bolts Used On Rear Shock Absorber Upper Mount

***OVERVIEW:***

This bulletin involves replacing the rear shock absorber upper mount bolts.

***MODELS:***

2015	(WK)	Jeep Grand Cherokee
2015	(WD)	Dodge Durango

**NOTE: This bulletin applies to vehicles built on or after November 24, 2014 (MDH 1124XX) and on or before December 04, 2014 (MDH 1204XX).**

***SYMPTOM/CONDITION:***

Incorrect bolts used on the rear shock absorber upper mounts.

***DIAGNOSIS:***

If a customer's VIN is listed in VIP or your RRT VIN list, perform the Repair Procedure.

***PARTS REQUIRED:***

Qty.	Part No.	Description
4	06105064AA	BOLT, Hex Flange Head, M10x1.50x35.00

**REPAIR PROCEDURE:**

**WARNING:**All pressurized air suspension components contain high pressure air (up to 220 psig). Use extreme caution when inspecting for leaks. Wear safety goggles and adequate protective clothing when inspecting or servicing the air suspension system. A sudden release of air under this amount of pressure can cause possible serious or fatal injury.

**WARNING:**Support the vehicle by supplemental means before performing any work on the air suspension system to prevent the vehicle from changing height. Before any given component is to be serviced it must be deflated. Servicing the air suspension system without supplemental support, or with pressure in the specific component, can cause possible serious or fatal injury.

1. If equipped with Air Suspension (SER), with a scan tool, using the routines under the Air Suspension Control Module (ASCM), perform the following:
  - Disable the air suspension system.
  - Run the Spring Deflate To Reservoir routine on the rear air suspension springs.
2. Raise and support the vehicle. Refer to the detailed service procedures available in DealerCONNECT> TechCONNECT under: Service Info> 04 - Vehicle Quick Reference> Hoisting> Standard Procedure.
3. Remove the tire and wheel.
4. Remove the two wheelhouse splash shield push pins (2) (Fig. 1).

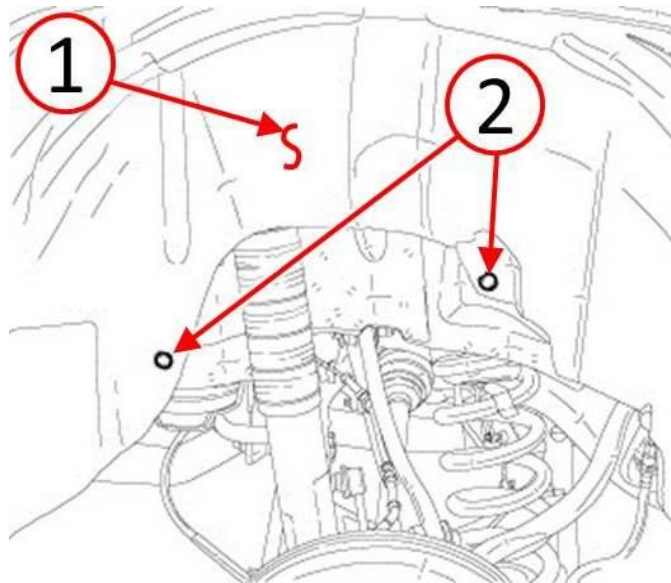
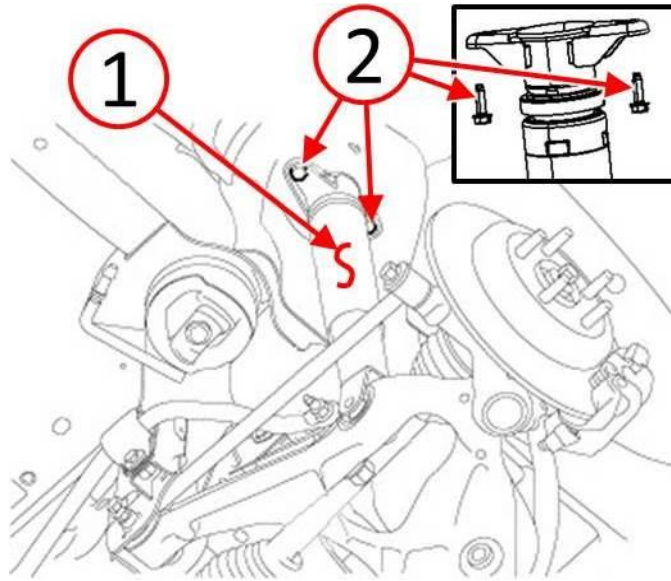

**Fig. 1 Wheelhouse Splash Shield - Remove Push Pins**

- 1 - Wheelhouse Splash Shield  
2 - Push Pins

- 
5. Support the outboard end of the lower control arm with a suitable holding fixture.
  6. Remove and discard the shock absorber upper mount bolts (2) (Fig. 2).

7. Install the NEW shock absorber upper mount bolts (2) and tighten to 65 N·m (48 ft. lbs.) (Fig. 2).



**Fig. 2 Shock Absorber - Replace Upper Bolts**

- 1 - Shock Absorber
- 2 - Upper Mount Bolts

- 
8. Install the two wheelhouse splash shield push pins (2) (Fig. 3).

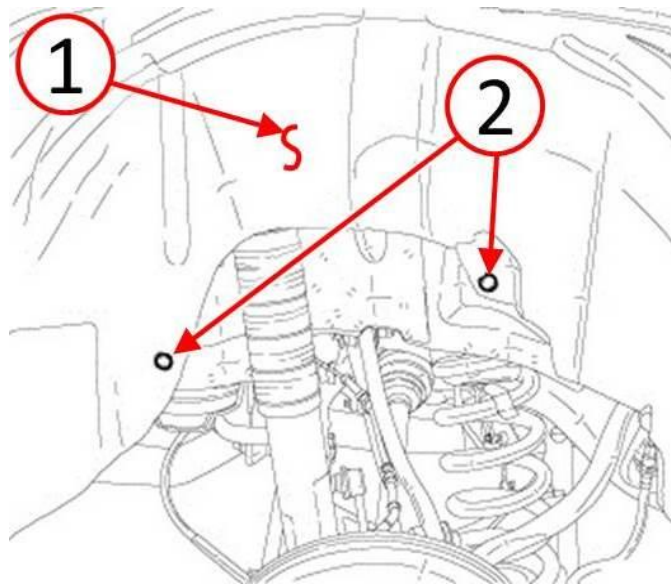

**Fig. 3 Wheelhouse Splash Shield - Install Push Pins**

- 1 - Wheelhouse Splash Shield
  - 2 - Push Pins
-

9. If equipped with Air Suspension (SER), with a scan tool, using the routines under the ASCM, perform the following:
  - Run the Fill Spring From Reservoir routine on the rear springs. Choose the Short Time Fill option from the menu selections and the spring will inflate for approximately one second, then verify the air spring is properly seated into its mounting sockets, and any wrinkles in the air bag have unfolded properly.
  - Run the Fill Spring From Reservoir routine on the rear springs. Choose the Complete Fill option from the menu selections.
10. Install the tire and wheel assembly. Refer to the detailed service procedures available in DealerCONNECT> TechCONNECT under: Service Info> 22 - Tires and Wheels> Wheels/Standard Procedure.
11. Remove the supports and lower the vehicle.
12. If equipped with Air Suspension (SER), with a scan tool, using the routines under the ASCM, perform the following:
  - Enable the air suspension system.
  - Command the vehicle to Normal Ride Height.
  - Run the Air Mass Calculation routine on the air suspension system.
  - If necessary, add to the system or deflate to atmosphere using the ASCM routines, then repeat the Air Mass Calculation routine again until system responds with Air Mass OK (188 - 216 bar-liters).
13. If equipped with Air Suspension (SER), perform the ASCM Verification Test. Refer to the detailed service procedures available in DealerCONNECT> TechCONNECT under: Service Info> 28 - DTC-Based Diagnostics> MODULE, Air Suspension Control (ASCM)> Standard Procedure.

**POLICY:**

Reimbursable within the provisions of the warranty.

**TIME ALLOWANCE:**

Labor Operation No:	Description	Skill Category	Amount
02-15-18-93	Bolts, Rear Upper Shock Mount - Replace Both Sides (1 - Semi-Skilled)	6 - Electrical and Body Systems	0.4 Hrs.
02-15-18-94	Bolts, Rear Upper Shock Mount - Replace Both Sides (Air Suspension (SER) ONLY) (1 - Semi-Skilled)	6 - Electrical and Body Systems	0.7 Hrs.

**FAILURE CODE:**

ZZ	Service Action
----	----------------